

PROPERTY INFORMATION

PARENT TAX PARCEL

- A. VALDOSTA LOWNDEN COUNTY
PARKS & RECREATION AUTHORITY
TAX PARCEL: 0076C 025
DEED BOOK 4379, PAGE 91, TRACT #6

ADJOINING TAX PARCELS

- B. VALDOSTA LOWNDEN COUNTY
PARKS & RECREATION AUTHORITY
TAX PARCEL: 0076C 024
DEED BOOK 4380, PAGE 245
- C. EAGER RIVER PROPERTY, LLC.
TAX PARCEL: 0079C 012
DEED BOOK 5828, PAGE 180
- D. LANGDALE CAPITAL ASSETS, INC.
TAX PARCEL: 0055 021
DEED BOOK 4500, PAGE 034
- E. MCCLANE FUNERAL SERVICES
TAX PARCEL: 0074 090
DEED BOOK 338, PAGE 521
- F. CARSON MCCLANE, INC.
TAX PARCEL: 0074 091
DEED BOOK 6825, PAGE 29
- G. C & B PROPERTIES, LLC.
TAX PARCEL: 0074 087
DEED BOOK 6672, PAGE 503
PLAT BOOK PC C, PAGE 582
- H. NSA PROPERTY HOLDINGS, LLC.
TAX PARCEL: 0074 088
DEED BOOK 6771, PAGE 510
- I. RIVERPLACE DEVELOPMENT, LLC.
TAX PARCEL: 0074 086
DEED BOOK 6826, PAGE 669
- J. RIVERPLACE DEVELOPMENT, LLC.
TAX PARCEL: 0076A 001
DEED BOOK 6826, PAGE 669

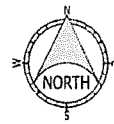
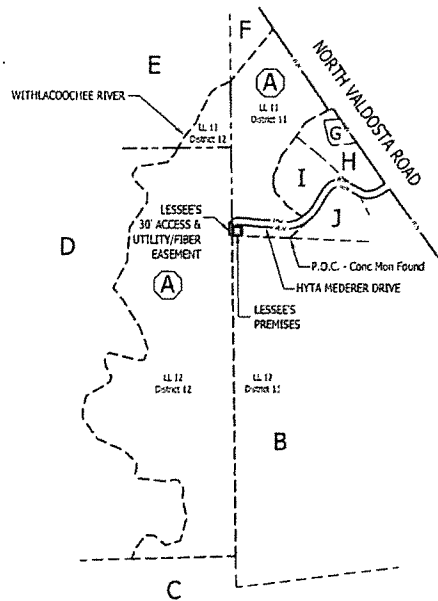

THE LAND CONSULTANTS
5449 Highway #41
Jackson, TN 37347
(423) 334-6722
Georgia C.O.A. No. LSF001190

PREPARED FOR
verizon
VERIZON WIRELESS

SPECIFIC PURPOSE SURVEY
BERMUDA RUN
Location Code: 503768
Hyta Mederer Drive, Valdosta, GA 31602
Land Lot 11, 11th District
Lowndes County, Georgia

OVERVIEW MAP

DATE: 12/24/20
ISSUE #: 1
ISSUE DATE: 06-15-2022
SEE SHEET # 1

SHEET
2
OF
5

OVERVIEW MAP CAUTION:
OVERVIEW MAP IS NOT A SURVEY BUT A VICINITY / LOCATION MAP INTENDED ONLY TO SHOW SURVEYED PROPERTY IN RELATION TO SURROUNDING AREA. VESTING AND ADJOINING PARCEL BOUNDARIES ARE NOT INCLUDED IN OR CERTIFIED BY THIS SURVEY. BOUNDARY LINES ARE A COMPOSITE OF DEED, PLAT AND/OR TAX MAP INFORMATION.

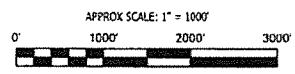

- PUBLIC R/W
- VESTING LAND
- ADJOINING TAX PARCEL
- APPROX LAND LOT LINE
- LESSEE'S PREMISES
- LESSEES EASEMENT(S)