

LEGEND

MS - 100' PER SEC - 2 1/2' RIBBON WITH CAP 20'00
 OF - 10' UNIMPAVED DRIVE
 0 - UNIMPAVED DRIVE
 1 - UNIMPAVED DRIVE
 2 - UNIMPAVED DRIVE
 3 - UNIMPAVED DRIVE
 4 - UNIMPAVED DRIVE
 5 - UNIMPAVED DRIVE
 6 - UNIMPAVED DRIVE
 7 - UNIMPAVED DRIVE
 8 - UNIMPAVED DRIVE
 9 - UNIMPAVED DRIVE
 10 - UNIMPAVED DRIVE
 11 - UNIMPAVED DRIVE
 12 - UNIMPAVED DRIVE
 13 - UNIMPAVED DRIVE
 14 - UNIMPAVED DRIVE
 15 - UNIMPAVED DRIVE
 16 - UNIMPAVED DRIVE
 17 - UNIMPAVED DRIVE
 18 - UNIMPAVED DRIVE
 19 - UNIMPAVED DRIVE
 20 - UNIMPAVED DRIVE
 21 - UNIMPAVED DRIVE
 22 - UNIMPAVED DRIVE
 23 - UNIMPAVED DRIVE
 24 - UNIMPAVED DRIVE
 25 - UNIMPAVED DRIVE
 26 - UNIMPAVED DRIVE
 27 - UNIMPAVED DRIVE
 28 - UNIMPAVED DRIVE
 29 - UNIMPAVED DRIVE
 30 - UNIMPAVED DRIVE
 31 - UNIMPAVED DRIVE
 32 - UNIMPAVED DRIVE
 33 - UNIMPAVED DRIVE
 34 - UNIMPAVED DRIVE
 35 - UNIMPAVED DRIVE
 36 - UNIMPAVED DRIVE
 37 - UNIMPAVED DRIVE
 38 - UNIMPAVED DRIVE
 39 - UNIMPAVED DRIVE
 40 - UNIMPAVED DRIVE
 41 - UNIMPAVED DRIVE
 42 - UNIMPAVED DRIVE
 43 - UNIMPAVED DRIVE
 44 - UNIMPAVED DRIVE
 45 - UNIMPAVED DRIVE
 46 - UNIMPAVED DRIVE
 47 - UNIMPAVED DRIVE
 48 - UNIMPAVED DRIVE
 49 - UNIMPAVED DRIVE
 50 - UNIMPAVED DRIVE
 51 - UNIMPAVED DRIVE
 52 - UNIMPAVED DRIVE
 53 - UNIMPAVED DRIVE
 54 - UNIMPAVED DRIVE
 55 - UNIMPAVED DRIVE
 56 - UNIMPAVED DRIVE
 57 - UNIMPAVED DRIVE
 58 - UNIMPAVED DRIVE
 59 - UNIMPAVED DRIVE
 60 - UNIMPAVED DRIVE
 61 - UNIMPAVED DRIVE
 62 - UNIMPAVED DRIVE
 63 - UNIMPAVED DRIVE
 64 - UNIMPAVED DRIVE
 65 - UNIMPAVED DRIVE
 66 - UNIMPAVED DRIVE
 67 - UNIMPAVED DRIVE
 68 - UNIMPAVED DRIVE
 69 - UNIMPAVED DRIVE
 70 - UNIMPAVED DRIVE
 71 - UNIMPAVED DRIVE
 72 - UNIMPAVED DRIVE
 73 - UNIMPAVED DRIVE
 74 - UNIMPAVED DRIVE
 75 - UNIMPAVED DRIVE
 76 - UNIMPAVED DRIVE
 77 - UNIMPAVED DRIVE
 78 - UNIMPAVED DRIVE
 79 - UNIMPAVED DRIVE
 80 - UNIMPAVED DRIVE
 81 - UNIMPAVED DRIVE
 82 - UNIMPAVED DRIVE
 83 - UNIMPAVED DRIVE
 84 - UNIMPAVED DRIVE
 85 - UNIMPAVED DRIVE
 86 - UNIMPAVED DRIVE
 87 - UNIMPAVED DRIVE
 88 - UNIMPAVED DRIVE
 89 - UNIMPAVED DRIVE
 90 - UNIMPAVED DRIVE
 91 - UNIMPAVED DRIVE
 92 - UNIMPAVED DRIVE
 93 - UNIMPAVED DRIVE
 94 - UNIMPAVED DRIVE
 95 - UNIMPAVED DRIVE
 96 - UNIMPAVED DRIVE
 97 - UNIMPAVED DRIVE
 98 - UNIMPAVED DRIVE
 99 - UNIMPAVED DRIVE
 100 - UNIMPAVED DRIVE

NOTES:

1. PROPOSED SUBDIVISION SHALL BE SHOWN BY... (text continues)
2. THE PROPERTY IS LOCATED IN THE... (text continues)
3. THE PROPERTY IS LOCATED IN THE... (text continues)
4. THE PROPERTY IS LOCATED IN THE... (text continues)
5. THE PROPERTY IS LOCATED IN THE... (text continues)
6. THE PROPERTY IS LOCATED IN THE... (text continues)
7. THE PROPERTY IS LOCATED IN THE... (text continues)
8. THE PROPERTY IS LOCATED IN THE... (text continues)
9. THE PROPERTY IS LOCATED IN THE... (text continues)
10. THE PROPERTY IS LOCATED IN THE... (text continues)
11. THE PROPERTY IS LOCATED IN THE... (text continues)
12. THE PROPERTY IS LOCATED IN THE... (text continues)
13. THE PROPERTY IS LOCATED IN THE... (text continues)
14. THE PROPERTY IS LOCATED IN THE... (text continues)
15. THE PROPERTY IS LOCATED IN THE... (text continues)
16. THE PROPERTY IS LOCATED IN THE... (text continues)
17. THE PROPERTY IS LOCATED IN THE... (text continues)
18. THE PROPERTY IS LOCATED IN THE... (text continues)
19. THE PROPERTY IS LOCATED IN THE... (text continues)
20. THE PROPERTY IS LOCATED IN THE... (text continues)
21. THE PROPERTY IS LOCATED IN THE... (text continues)
22. THE PROPERTY IS LOCATED IN THE... (text continues)
23. THE PROPERTY IS LOCATED IN THE... (text continues)
24. THE PROPERTY IS LOCATED IN THE... (text continues)
25. THE PROPERTY IS LOCATED IN THE... (text continues)
26. THE PROPERTY IS LOCATED IN THE... (text continues)
27. THE PROPERTY IS LOCATED IN THE... (text continues)
28. THE PROPERTY IS LOCATED IN THE... (text continues)
29. THE PROPERTY IS LOCATED IN THE... (text continues)
30. THE PROPERTY IS LOCATED IN THE... (text continues)
31. THE PROPERTY IS LOCATED IN THE... (text continues)
32. THE PROPERTY IS LOCATED IN THE... (text continues)
33. THE PROPERTY IS LOCATED IN THE... (text continues)
34. THE PROPERTY IS LOCATED IN THE... (text continues)
35. THE PROPERTY IS LOCATED IN THE... (text continues)
36. THE PROPERTY IS LOCATED IN THE... (text continues)
37. THE PROPERTY IS LOCATED IN THE... (text continues)
38. THE PROPERTY IS LOCATED IN THE... (text continues)
39. THE PROPERTY IS LOCATED IN THE... (text continues)
40. THE PROPERTY IS LOCATED IN THE... (text continues)
41. THE PROPERTY IS LOCATED IN THE... (text continues)
42. THE PROPERTY IS LOCATED IN THE... (text continues)
43. THE PROPERTY IS LOCATED IN THE... (text continues)
44. THE PROPERTY IS LOCATED IN THE... (text continues)
45. THE PROPERTY IS LOCATED IN THE... (text continues)
46. THE PROPERTY IS LOCATED IN THE... (text continues)
47. THE PROPERTY IS LOCATED IN THE... (text continues)
48. THE PROPERTY IS LOCATED IN THE... (text continues)
49. THE PROPERTY IS LOCATED IN THE... (text continues)
50. THE PROPERTY IS LOCATED IN THE... (text continues)
51. THE PROPERTY IS LOCATED IN THE... (text continues)
52. THE PROPERTY IS LOCATED IN THE... (text continues)
53. THE PROPERTY IS LOCATED IN THE... (text continues)
54. THE PROPERTY IS LOCATED IN THE... (text continues)
55. THE PROPERTY IS LOCATED IN THE... (text continues)
56. THE PROPERTY IS LOCATED IN THE... (text continues)
57. THE PROPERTY IS LOCATED IN THE... (text continues)
58. THE PROPERTY IS LOCATED IN THE... (text continues)
59. THE PROPERTY IS LOCATED IN THE... (text continues)
60. THE PROPERTY IS LOCATED IN THE... (text continues)
61. THE PROPERTY IS LOCATED IN THE... (text continues)
62. THE PROPERTY IS LOCATED IN THE... (text continues)
63. THE PROPERTY IS LOCATED IN THE... (text continues)
64. THE PROPERTY IS LOCATED IN THE... (text continues)
65. THE PROPERTY IS LOCATED IN THE... (text continues)
66. THE PROPERTY IS LOCATED IN THE... (text continues)
67. THE PROPERTY IS LOCATED IN THE... (text continues)
68. THE PROPERTY IS LOCATED IN THE... (text continues)
69. THE PROPERTY IS LOCATED IN THE... (text continues)
70. THE PROPERTY IS LOCATED IN THE... (text continues)
71. THE PROPERTY IS LOCATED IN THE... (text continues)
72. THE PROPERTY IS LOCATED IN THE... (text continues)
73. THE PROPERTY IS LOCATED IN THE... (text continues)
74. THE PROPERTY IS LOCATED IN THE... (text continues)
75. THE PROPERTY IS LOCATED IN THE... (text continues)
76. THE PROPERTY IS LOCATED IN THE... (text continues)
77. THE PROPERTY IS LOCATED IN THE... (text continues)
78. THE PROPERTY IS LOCATED IN THE... (text continues)
79. THE PROPERTY IS LOCATED IN THE... (text continues)
80. THE PROPERTY IS LOCATED IN THE... (text continues)
81. THE PROPERTY IS LOCATED IN THE... (text continues)
82. THE PROPERTY IS LOCATED IN THE... (text continues)
83. THE PROPERTY IS LOCATED IN THE... (text continues)
84. THE PROPERTY IS LOCATED IN THE... (text continues)
85. THE PROPERTY IS LOCATED IN THE... (text continues)
86. THE PROPERTY IS LOCATED IN THE... (text continues)
87. THE PROPERTY IS LOCATED IN THE... (text continues)
88. THE PROPERTY IS LOCATED IN THE... (text continues)
89. THE PROPERTY IS LOCATED IN THE... (text continues)
90. THE PROPERTY IS LOCATED IN THE... (text continues)
91. THE PROPERTY IS LOCATED IN THE... (text continues)
92. THE PROPERTY IS LOCATED IN THE... (text continues)
93. THE PROPERTY IS LOCATED IN THE... (text continues)
94. THE PROPERTY IS LOCATED IN THE... (text continues)
95. THE PROPERTY IS LOCATED IN THE... (text continues)
96. THE PROPERTY IS LOCATED IN THE... (text continues)
97. THE PROPERTY IS LOCATED IN THE... (text continues)
98. THE PROPERTY IS LOCATED IN THE... (text continues)
99. THE PROPERTY IS LOCATED IN THE... (text continues)
100. THE PROPERTY IS LOCATED IN THE... (text continues)

SUBDIVISION PLAT FOR:
WEST SCHOOLHOUSE POND SUBDIVISION

DATE OF SURVEY: 04-23-2012
 DATE OF PLAT: 07-01-12
 PROJECT NUMBER: 0001001

SCALE: 1 INCH = 100 FEET

7700 West Peachtree Road
 Atlanta, GA 30340
 Telephone: 770-415-1500
 Fax: 770-415-1501
 E-mail: info@gl.com
 G.L. & M. SURVEYING & MAPPING

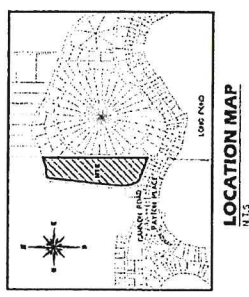

SITE INFORMATION

MUNICIPALITY: LOWWATER COUNTY
 MAP ORS: PARCEL 003
 TOTAL AREA: 21.83 ACRES
 CURRENT ZONING: R-10
 APPROX. LOT WIDTH: 80'
 APPROX. LOT DEPTH: 30' FROM R/W
 COOPER: 24' FROM R/W
 COUNTY UNITIES ELIMINATED

WE, THE UNDERSIGNED ENGINEER, AT THE 2183 JUNE TRACT... (text continues)

DATE: _____
 DATE: _____
 DATE: _____

APPROVED BY BOARD OF HEALTH, LOWWATER COUNTY, GEORGIA
 BOARD OF HEALTH REPRESENTATIVE: _____
 DATE: _____

APPROVED BY THE COUNTY ENGINEER
 COUNTY ENGINEER: _____
 DATE: _____

DIRECTOR OF ENGINEERING: _____
 DATE: _____



CERTIFICATION:

AS REQUIRED BY REGULATION 101 OF O.C.G.A., SECTION 16-6-41, THIS PLAT HAS BEEN... (text continues)

ADAM J. GIBBS
 GEORGIA REGISTERED PROFESSIONAL SURVEYOR
 No. 1199

DATE: _____
 DATE: _____

LOWWATER COUNTY UNIFIED DEVELOPMENT DISTRICT
 APPROVAL: CHAIRMAN, TECHNICAL REVIEW COMMITTEE

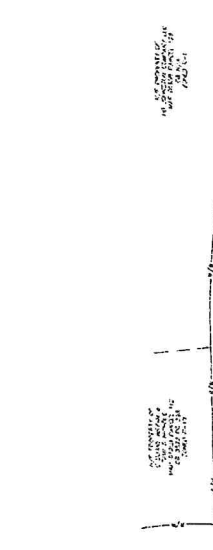

PREPARED FOR: DEPT. OF SURVEYS, STATE

BENCHMARK #	ELEVATION	NORTHING	EASTING	TYPE
BM #1	165.231'	24641.3730	462094.8500	PK. HAL.
BM #2	167.992'	25782.5231	260756.8500	PK. HAL.
BM #3	167.939'	23809.6600	260178.9110	PK. HAL.
BM #4	167.967'	25488.8240	263179.6640	PK. HAL.
BM #5	165.234'	259396.1100	2620236.1370	PK. HAL.
BM #6	161.607'	254905.2015	2622249.8120	PK. HAL.

FLOOD CERTIFICATION

THIS PROPERTY IS LOCATED IN THE... (text continues)

EFFECTIVE DATE: 02/24/2008

SURVEYOR'S NOTES:

1. G.L. MAKES NO GUARANTEE THAT ALL EXISTING UTILITIES HAVE BEEN IDENTIFIED... (text continues)
2. SUBJECT PROPERTY... (text continues)
3. HORIZONTAL AND VERTICAL DATA SHOWN ON THIS PLAT WAS OBTAINED IN WHOLE... (text continues)
4. THIS SURVEY... (text continues)
5. A CURRENT TITLE SEARCH OR ABSTRACT OF MATTERS... (text continues)