

15/03/2023 10:57:11 AM Arrow Engineering & Construction Services, Inc. 01/2023 1:10 PM

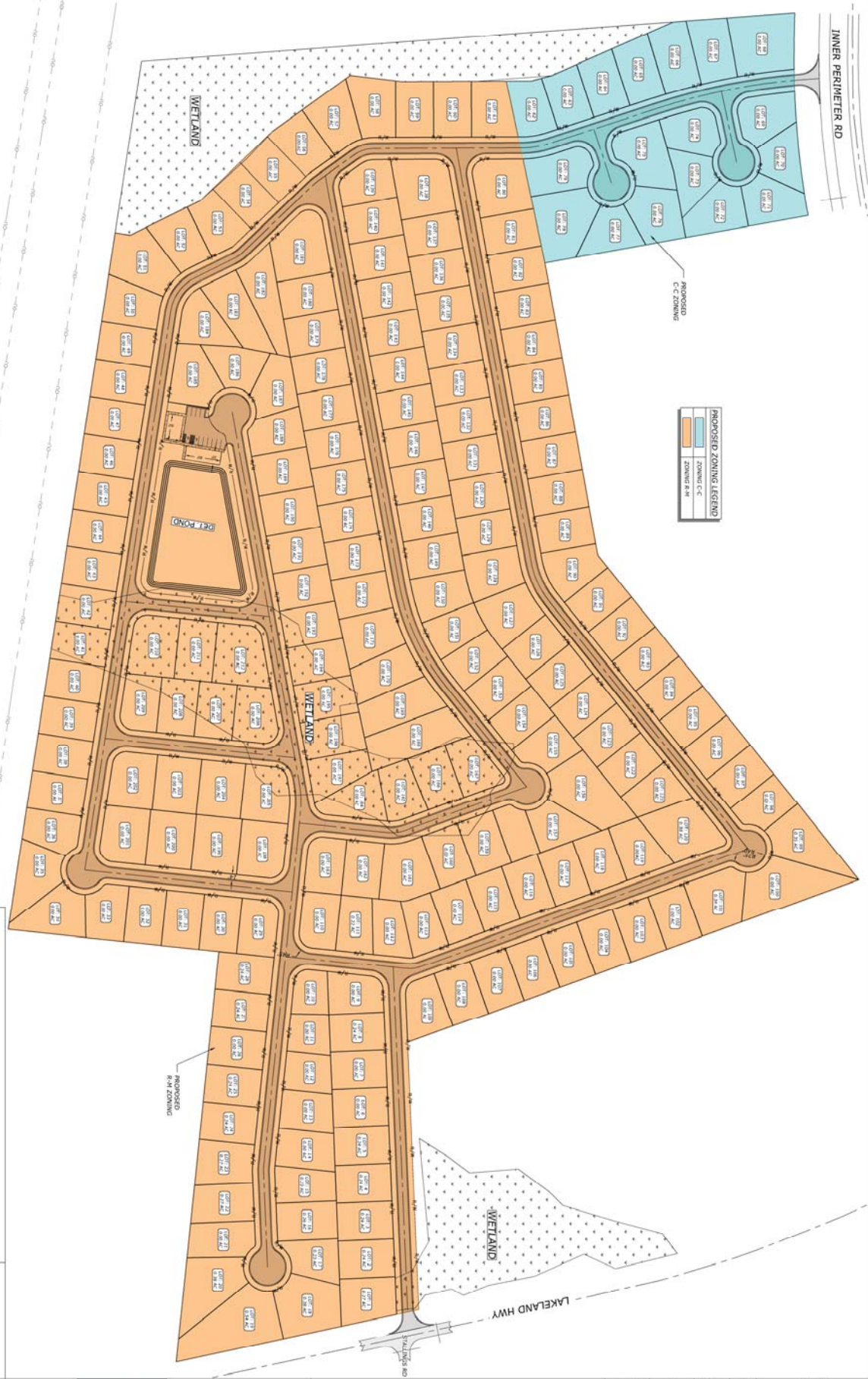

PROPOSED ZONING LEGEND

	ZONING C-C
	ZONING R-R

CONCEPTUAL LOT LAYOUT

MAX. POTENTIAL LOTS = 212



NOTICE: LOCATIONS OF UTILITIES SHOWN ARE APPROXIMATE. PLEASE CONTACT GEORGIA 811 BEFORE ANY CONSTRUCTION SERVICES ARE PERFORMED. ARROW ENGINEERING & CONSTRUCTION SERVICES, INC. DOES NOT WARRANT THE ACCURACY OF THE INFORMATION SHOWN. ANY INFORMATION SHOWN IS FOR INFORMATIONAL PURPOSES ONLY AND DOES NOT CONSTITUTE A CONTRACT. TO OBTAIN ACCURATE UTILITY LOCATIONS, PLEASE CONTACT GEORGIA 811.



PROJECT: 23007
SHEET
C.2.0



ARROW ENGINEERING & CONSTRUCTION SERVICES
3021 WOLF CREEK EAST
VALDOSTA, GA 31606
770.553.5130
LSANDERS@ARROWENGINEERING.COM

**PROPOSED ZONING PLAN FOR:
NEW SUBDIVISION
LAKELAND HIGHWAY
LOCATED IN LL 150 OF THE 11TH L.D.
VALDOSTA, GA**

DRAWN BY	GNS	DATE	BY	DESCRIPTION
CHECKED BY	HLJ			
PROJECT	23007			
CAD FILE				
DATE	6/24/2023			

© COPYRIGHT 2023. THIS DRAWING IS THE PROPERTY OF ARROW ENGINEERING AND CONSTRUCTION SERVICES AND MAY NOT BE REPRODUCED OR TRANSMITTED IN ANY FORM OR BY ANY MEANS, ELECTRONIC OR MECHANICAL, INCLUDING PHOTOCOPYING, RECORDING, OR BY ANY INFORMATION STORAGE AND RETRIEVAL SYSTEM, WITHOUT PERMISSION IN WRITING FROM ARROW ENGINEERING AND CONSTRUCTION SERVICES.