

REZONING SURVEY PLAT FOR

ANTHONY TONG

BEING IN LAND LOT 61 OF THE
11TH LAND DISTRICT, VALDOSTA,
LOWNDES COUNTY, GEORGIA

SURVEY DATE: FEBRUARY 16, 2023
PLAT DATE: FEBRUARY 17, 2023



GRAPHIC SCALE : 1 INCH = 30 FT.

I hereby certify that this property is located in a "X" zone,
and not within a 100-yr flood zone according to the Federal
Emergency Management Agency's Insurance Rate Map
Panel Number 13185C0210E, Dated 9-26-08.

THIS SURVEY WAS PREPARED IN CONFORMITY
WITH THE TECHNICAL STANDARDS FOR
PROPERTY SURVEYS IN GEORGIA AS SET FORTH
IN CHAPTER 180-7 OF THE RULES OF THE
GEORGIA BOARD OF REGISTRATION FOR
PROFESSIONAL ENGINEERS AND LAND
SURVEYORS AND AS SET FORTH IN THE
GEORGIA PLAT ACT O.C.G.A. 15-6-67.



EAST JANE STREET (100' R/W)
(DIVIDED ROAD WITH LANDSCAPED MEDIAN)

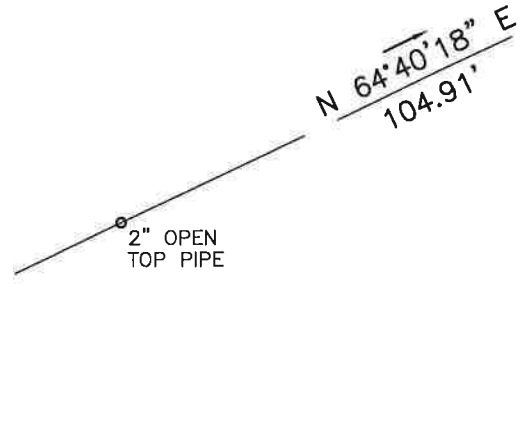
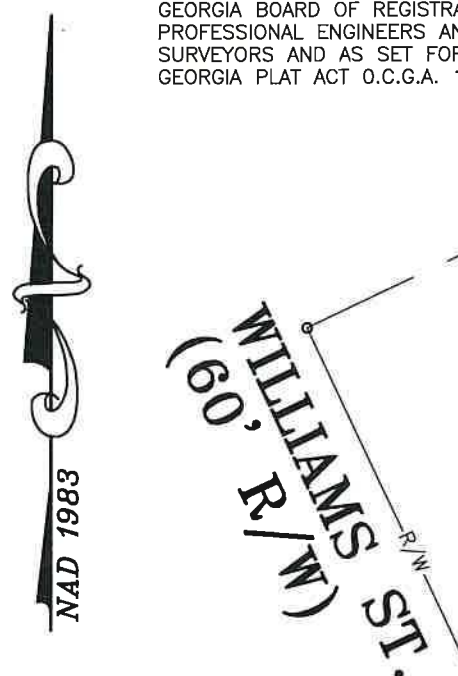

PROPERTY OF
EJA COMPANY, LLC
TAX MAP 116C, PAR 63
DB 6659, PG 931
PB 31, PG 72

PROPERTY OF
JERRY & LINDA DAVIS
TAX MAP 116C, PAR 58
DB 3125, PG 25

PROPERTY OF
CLIFTON THOMAS COPPAGE
TAX MAP 116C, PAR 65
DB 1166, PG 286

PROPERTY OF
CHARLENE MONTGOMERY
TAX MAP 116C, PAR 56
DB 484, PG 412

PROPERTY OF
SANDY MAC
PROPERTIES, LLC
ZONED R-P
TAX MAP 0116C,
PAR 064
DB 6924, PG 142

0.326 ACRES
ASPHALT PARKING

AC	- AIR CONDITIONER
GV	- GAS VALVE/METER
IPS	- IRON PIN SET - 5/8" REBAR
R/W	- RIGHT OF WAY
--X--X--	- FENCE
⊙	- POWER POLE
OU	- OVERHEAD UTILITY
↙	- GUY WIRE

EQUIPMENT USED: TOPCON PS-103A "TOTAL STATION"
THE FIELD DATA UPON WHICH THIS
SURVEY WAS PREPARED HAS A
POSITIONAL TOLERANCE OF PROPERTY
CORNERS WITH RESPECT TO EACH
OTHER OF 0.02 FEET.
PLAT CLOSURE: 1'/109,953
BEARINGS SHOWN WERE CALCULATED FROM
FIELD ANGLES TURNED REFERENCED TO
NAD 1983 GEORGIA WEST ZONE

**Southeastern
Surveying, Inc.**

601 N. St. Augustine Rd. Telephone: 229-259-9455
Valdosta, GA 31601 Fax: 229-259-9926
E-mail: bherring@sesurveying.com
GA Certificate of Authorization No. 685

NAD 1983

WILLIAMS ST.
(60' R/W)

ASA #06