

PROPERTY DATA SUMMARY

OWNER/APPLICANT:
 BOVALDOSTA, LLC
 C/O BRAD FOLSOM
 3320 BELLEMEADE DRIVE
 VALDOSTA, GA 31602
 PH: (229) 245-7823

PROJECT INFO:
 ADDRESS: 940 GA HWY 122 W
 ZONING: C-H
 PIN: PART OF MAP 0026 PARCEL 033
 ACREAGE: 2.64 AC

BUILDING DATA:
 PROPOSED COMBINATION OF
 2,616 SQ.FT. RESTAURANT AND
 4,031 SQ.FT. CONVENIENCE STORE

PARKING DATA:
 1/100 SQ.FT. GFA OF RESTAURANT
 2/GAS DISPENSER
 1/200 SQ.FT. GFA FOR RETAIL
 REQUIRED = 62
 PROVIDED = 71
 HC REQUIRED = 3
 HC PROVIDED = 3

STORMWATER RUNOFF SHALL BE DIRECTED TO SWALES AND CONVEYED TO ON-SITE DETENTION FACILITY

PARKING LOT LIGHTING SHALL CONFORM TO SECTION 4-5.7

N/F PROPERTY OF
 WC INVESTMENT AND
 DEVELOPMENT CO LP
 MAP 0026 PARCEL 033
 ZONED C-H

N/F PROPERTY OF
 KIT HAROLD ROBINSON AND
 LEANN VIRGINIA ROBINSON
 MAP 0026 PARCEL 034
 ZONED C-H

N/F PROPERTY OF
 NORTHSIDE PROPERTY
 HOLDINGS LLC
 MAP 0026 PARCEL 033A
 ZONED C-H

WETLANDS (DELINEATED
 BY RED OAK ENVIRONMENTAL
 JUNE 2020)

N/F PROPERTY OF
 WC INVESTMENT AND
 DEVELOPMENT CO LP
 MAP 0026 PARCEL 033
 ZONED C-H

DATE	DESCRIPTION

BOJANGLES HAHIRA
 HAHIRA, LOWNDES COUNTY, GEORGIA
 LAND LOT 96 LAND DISTRICT 12TH

INNOVATE!
 Engineering & Surveying
 PHONE: 229-249-9113 - www.innovatees.com
 2214 N. Patterson Street, Valdosta, GA 31602

NOT FOR
 CONSTRUCTION

DATE:
 12/20/2022
 DRAWN BY:
 M. WILSON
 CHECKED BY:
 B. KENT

SHEET
 1 OF 1

PROJECT NUMBER
 1791

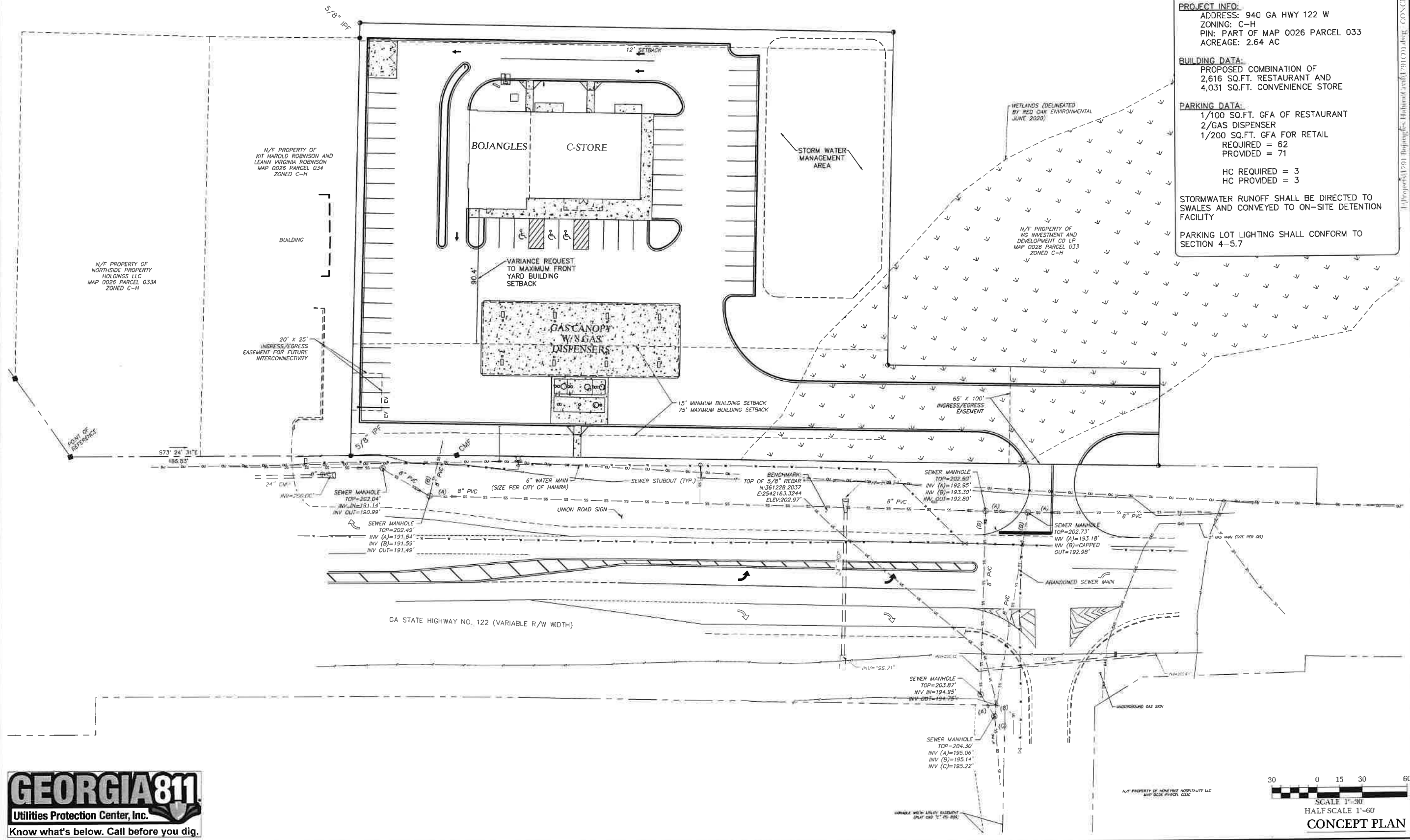

GEORGIA811
 Utilities Protection Center, Inc.
 Know what's below. Call before you dig.

SCALE 1"=30'
 HALF SCALE 1"=60'
CONCEPT PLAN