

**PLAT OF REZONING FOR:**  
**DPI HOLDINGS, LLC**

LYING AND BEING IN  
 LAND LOT 60 OF THE 11TH LAND DISTRICT  
 OF THE CITY OF VALDOSTA,  
 LOWNDES COUNTY, GEORGIA

DATE: NOVEMBER 16, 2021

**ZONING NOTES**

THE SUBJECT PROPERTY IS ZONED  
 R-10 (SINGLE FAMILY RESIDENTIAL)  
 AND THE PROPOSED ZONING IS R-M.

**MINIMUM BUILDING SETBACKS**

FOR R-10:  
 FRONT-20 FEET  
 SIDE-10 FEET  
 REAR-25 FEET

FOR R-M:  
 FRONT-15 FEET  
 \*SIDE-8 FEET  
 REAR-25 FEET

\*20' FOR MULTI-FAMILY WITH 3 OR  
 MORE FLOORS

**FLOOD CERTIFICATION**

THIS PROPERTY IS LOCATED IN AN "X"  
 ZONE, WHICH IS DESIGNATED AS "AREAS  
 DETERMINED TO BE OUTSIDE THE 0.2%  
 ANNUAL CHANCE FLOODPLAIN", ACCORDING  
 TO THE FEDERAL EMERGENCY MANAGEMENT  
 AGENCY'S FLOOD INSURANCE RATE MAP  
 13185C0210E, DATED 09/26/2008.

© COPYRIGHT

THIS DRAWING IS THE PROPERTY OF ASA ENGINEERING  
 & SURVEYING, INC. AND MAY NOT BE REPRODUCED  
 WITHOUT WRITTEN PERMISSION. DOCUMENTS OF  
 PUBLIC RECORD MAY BE COPIED BUT NOT ALTERED.



**ASA ENGINEERING  
 & SURVEYING, LLC.**

103A S. PATTERSON ST. - VALDOSTA, GA 31601  
 PH.: (229) 244-0596 - INFO@ASAENG.COM - LSF 000380



GRAPHIC SCALE : 1 INCH = 30 FT.

NOTE: NO UNDERGROUND UTILITIES WERE VERIFIED  
 OR FIELD LOCATED ON THE PROPERTY SHOWN HEREON.

ASA ENGINEERING & SURVEYING, LLC. DOES NOT GUARANTEE  
 THAT ALL EASEMENTS WHICH MAY AFFECT THE PROPERTY  
 ARE SHOWN HEREON AND ASSUMES NO LIABILITY FOR  
 FAILURE TO CONFIRM UTILITY LOCATIONS PRIOR TO ANY  
 DIGGING OR CONSTRUCTION.

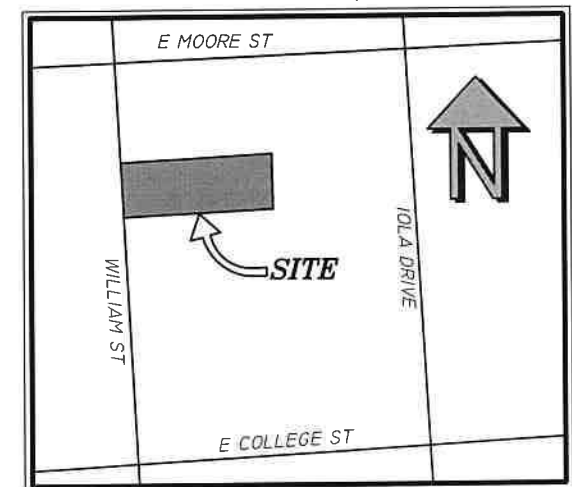

**LOCATION MAP**

NOT TO SCALE

DRAWN BY: ALH  
 5960 REZONING.DWG  
 5960.CRD